



PARTIAL COLUMN WRAP SHOWN FOR DISPLAY PURPOSES ONLY

RESOLVE GLT™

**Specify RESOLVE GLT™.
Eliminate waste.
Wrap structural steel in the
visual language of mass timber.**

Exposed steel columns, beams, and stair structures can disrupt the warmth and continuity of wood-forward interiors. Timberlab RESOLVE GLT™ addresses that challenge, providing a sustainably sourced glulam-matched finish that visually integrates elements into mass timber environments, wrapping columns, beams, and stair assemblies with furniture-grade precision. Integrated tongue-and-groove edges ensure simple scaling, fast alignment, and a seamless transition between structural wood and concealed steel.



SAMPLE DETAIL

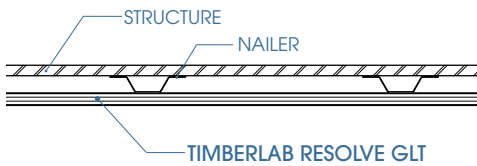

SPECIES

Standard:

- Douglas Fir (DF)

Special Order:

- Southern Yellow Pine (SYP)
- Spruce Pine Fir (SPF)
- Alaskan Cedar (AYC)

SUSTAINABILITY

- Upcycled manufacturing waste
- LEED v5 MRc4 Compliant

SPECIFICATIONS

NOMINAL SIZE	24" x 96"
THICKNESS	.75"
TOLERANCE	±.012"
EDGE PROFILE	T&G (all edges)
FINISH	Finish ready

SALES & RESOURCES

06 4200 Timberlab Resolve GLT Spec
info@timberlab.com
 503.749.7500

FEATURES

Sustainable Sourcing. RESOLVE GLT™ is manufactured utilizing salvaged glulam, giving non-structural and reclaimed glulam a second life in the built environment.

Tongue & Groove Profile. Our T&G profile allows for cost-efficient installation while maintaining seamless transitions between panels.

Matches the palette. Made of common species used in mass timber construction to maintain a consistent wood aesthetic throughout the building.



ADDITIONAL USES

